

Model 4940 Adapter, TNC Female To TNC Female

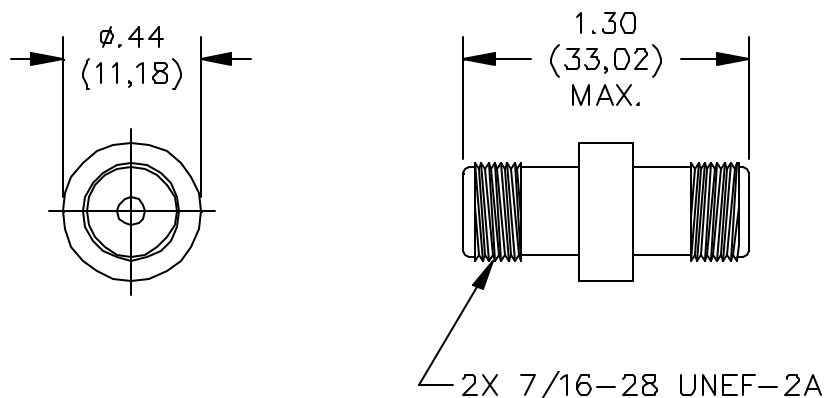

MATERIALS:

Body and Fittings: Brass per QQ-B-626, Alloy 360, 1/2 hard

Center Contacts: Gold Plated Beryllium Copper per QQ-C-530, Cond. HT.

Dielectric: PTFE

Finish:

Body and Fittings: Tarnish Resistant

Center Contacts: Gold plated per requirements of MIL-C-39012

Marking: "POMONA 4940"

RATINGS:

Operating Voltage: 500 VRMS

Nominal Impedance: 50 Ohms

ORDERING INFORMATION: Model 4940

All dimensions are in inches. Tolerances (except noted): .xx = ±.02" (.51 mm), .xxx = ±.005" (.127 mm).

All specifications are to the latest revisions. Specifications are subject to change without notice.

Registered trademarks are the property of their respective companies.

Made in USA